

ABOUT THE COLLECTION

We are proud to introduce the Island series which features three car garages, resort style bedrooms and bathrooms and outdoor lanai floor plan summer kitchen and large gathering area for family and friends.

Best of all you will be in one of our fine communities made for people like yourselves who enjoy the rewards from a lifetime of hard work.



ABOUT THE BUILDER

For the past 30 years, Premier Homes has been the leading innovator in the Wilmington area's housing and community development marketplace. With a portfolio of over 30 communities and more than 4,000 homes and home sites developed, Premier Homes specializes in the art of offering active adults, home designs and communities perfectly suited to the areas many amenities and attractions.



Phone: 910-799-6830

Fax: 910-799-6831

E-mail: info@PremierHomesAtMottsLanding.com

The ISLAND COLLECTION



THE BERMUDA

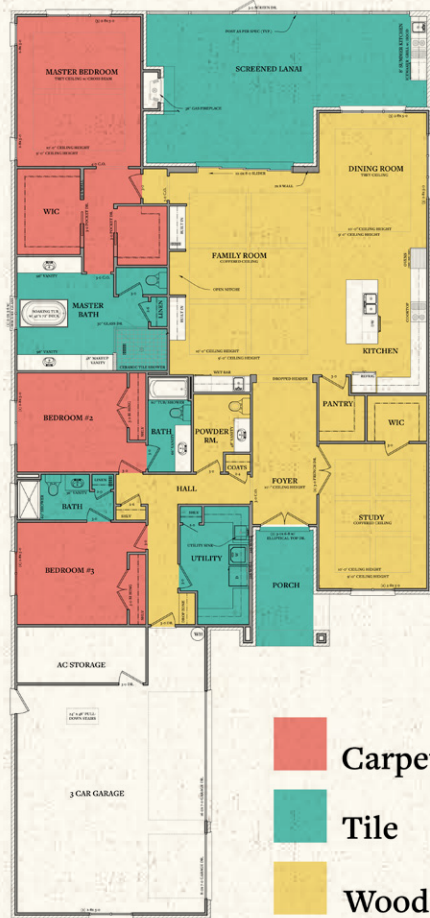

3,210 Heated Sq. Ft.

FEATURES

- 3 Bedrooms
- 3.5 Baths
- Study
- Coffered and Tray Ceiling
- Screened Lanai
- Fireplace
- Climate-Controlled Storage

This floor plan illustrates a general plan which is subject to future change and revisions. Dimensions, boundaries and position locations are for illustrative purposes only and are not necessarily intended to be exact.

TURKS-N-CAICOS

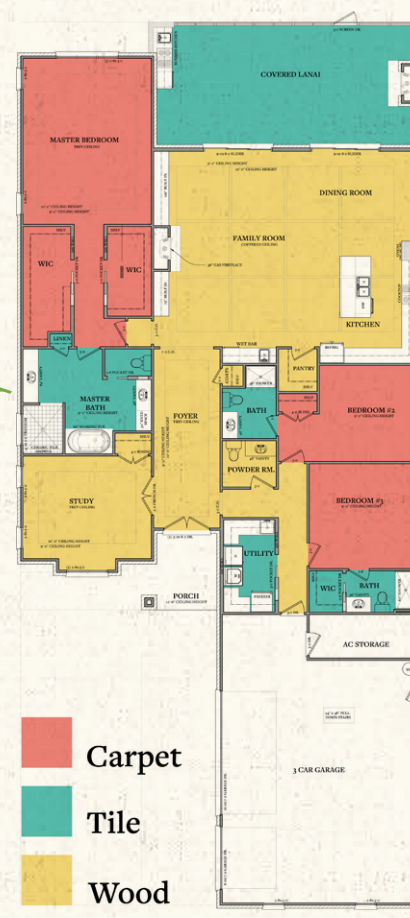

3,175 Heated Sq. Ft.

FEATURES

- 3 Bedrooms
- 3.5 Baths
- Screened Lanai
- Fireplace
- Climate-Controlled Storage
- Study
- Coffered and Tray Ceiling

This floor plan illustrates a general plan which is subject to future change and revisions. Dimensions, boundaries and position locations are for illustrative purposes only and are not necessarily intended to be exact.

THE CAYMAN



2,610 Heated Sq. Ft.

FEATURES

- 3 Bedrooms
- 3 Baths
- Study
- Coffered and Tray Ceiling
- Screened Lanai
- Fireplace
- Climate-Controlled Storage

This floor plan illustrates a general plan which is subject to future change and revisions. Dimensions, boundaries and position locations are for illustrative purposes only and are not necessarily intended to be exact.